

Basic mobil

Nr. 2914

***Bedienungsanleitung
Instruction manual • Mode d'emploi
Istruzioni d'uso • Instrucciones para el servicio
Инструкция по эксплуатации
取扱説明書 • 사용 설명서***

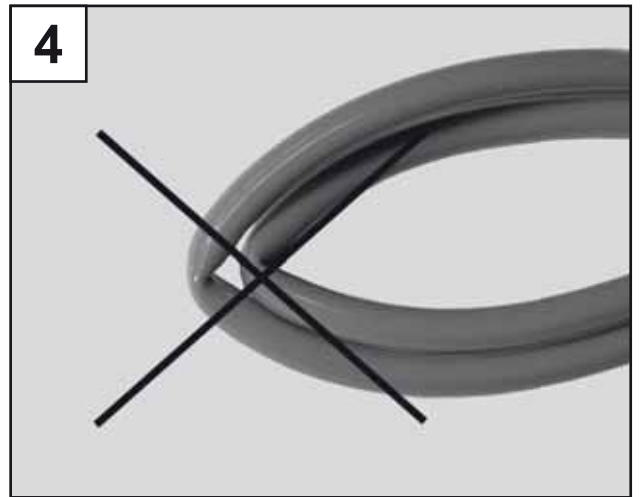

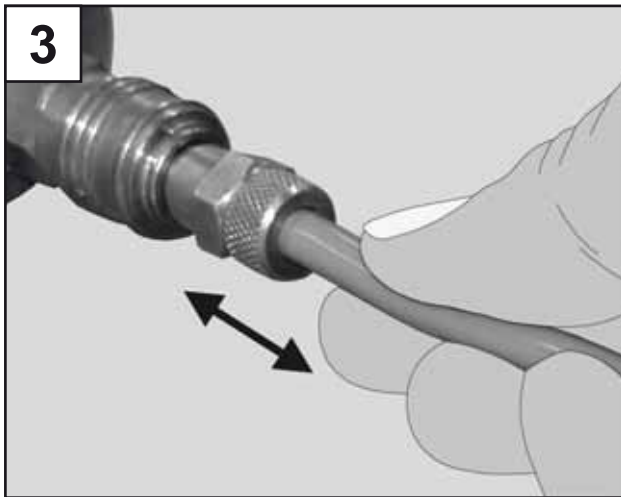
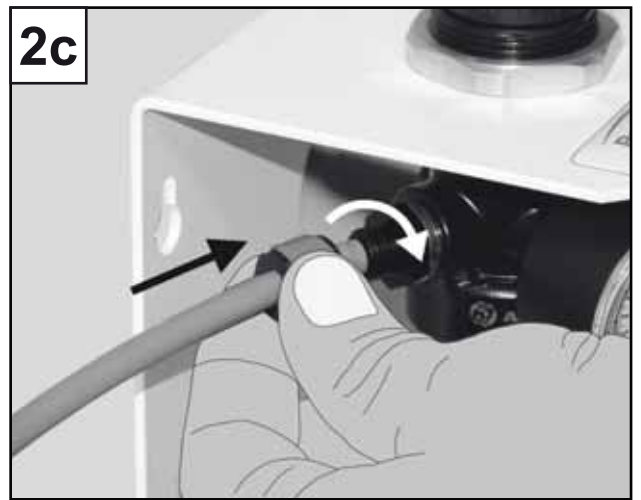
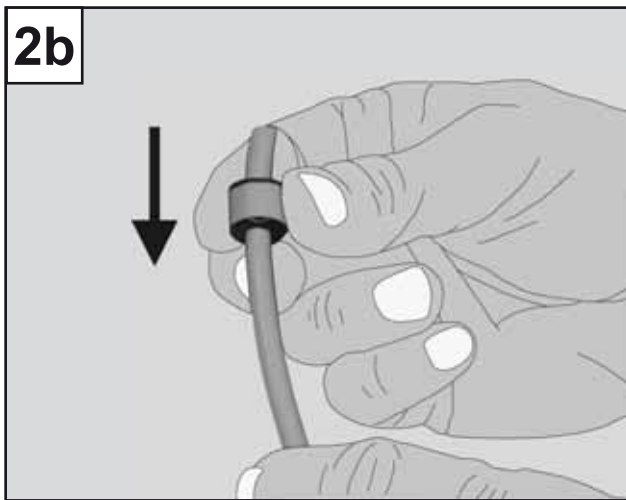
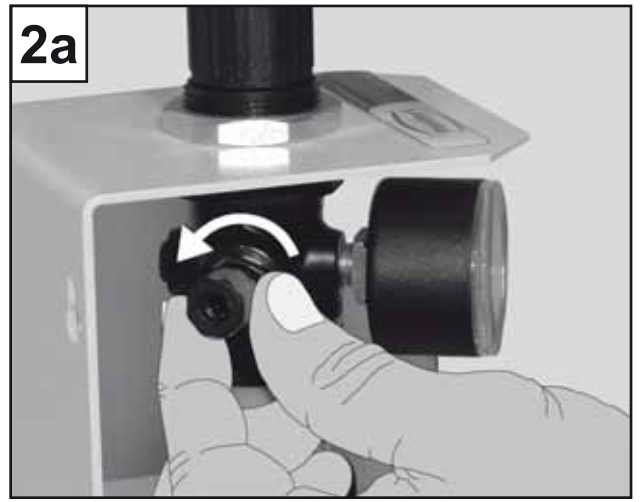

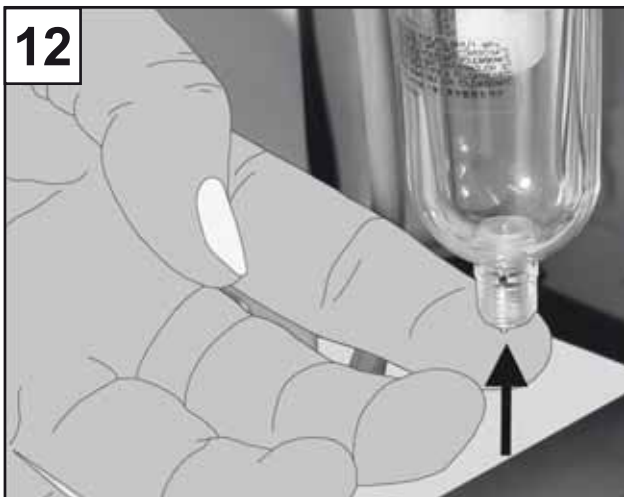
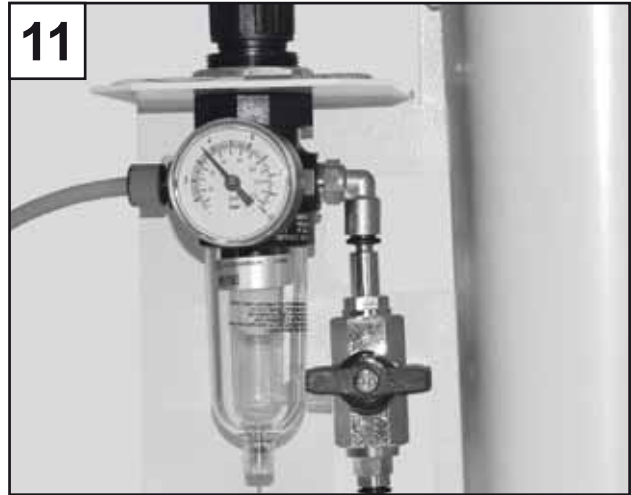
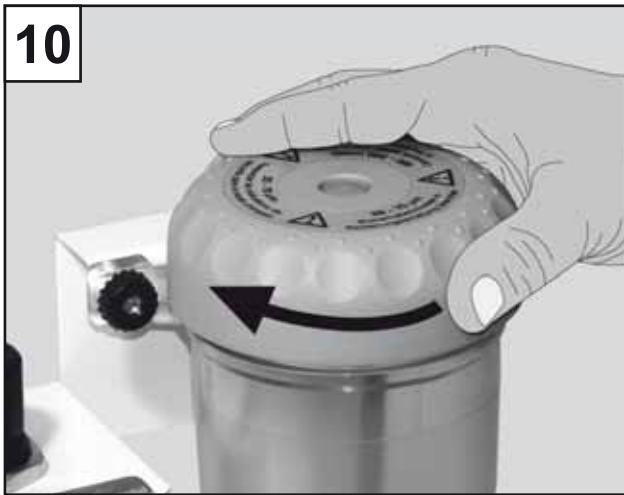
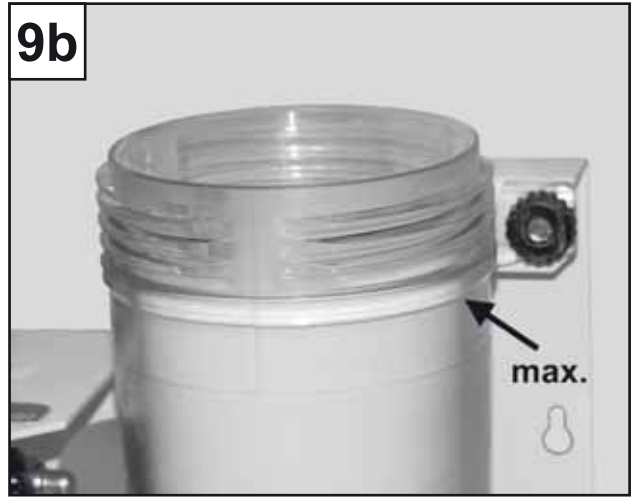
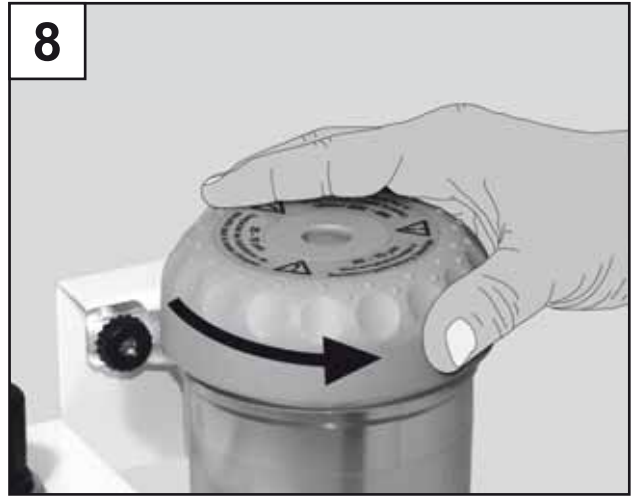
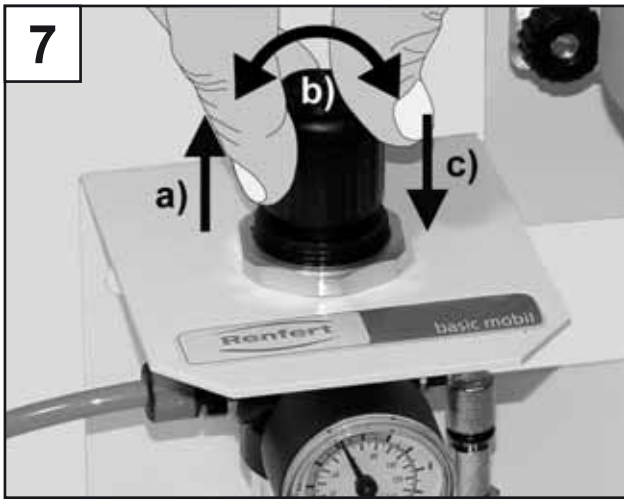

Basic mobil

No. 2914

ENGLISH

1. Introduction

We are pleased with your decision to purchase the *Basic mobil*. The mobile sandblasting unit is connected to the compressed air or to the recyclable blaster *Vario-Jet* resp. *Vario basic*.

2. Application Area

The *Basic* line of sandblasting units are designed for use in dental laboratories to remove investment residues, oxides on cast objects, and for surface treatment.

3. Safety Information

- Always disconnect the unit from the compressed air and power sources prior to beginning any maintenance work.
- When working on the tank (filling up, cleaning, maintenance) wear protective glasses for protecting your eyes.
- Any residue of abrasive material on the gasket may lead to leakage and early wear of the gasket. After filling up clean the thread and the gasket and close the lid properly.
- Solvents and tensides can create micro-cracking in the plastic (danger of explosion!). Clean the tank and the lid only with a dry cloth. Do not write or stick something on the tanks.
- Check the tanks and the lids regularly on damages and replace them in case of doubt.
- Check the tank cover for correct seating prior to beginning operation. Covers that are not securely closed can suddenly be blown off as the tank pressure increases. The resulting flying parts and abrasive represent a serious hazard.
- **Never** operate the blasting units without suitable dust extraction and appropriate protective gear, as this could result in **health hazards**. The type of dust extraction should be selected on the basis of the dust being generated. Follow here **absolutely** EN 60335-2-69 appendix AA or ask the appropriate authorities.
- Improper use can result in the risk of eye or skin injuries.
- **Never** direct the blasting material towards eyes or unprotected areas of skin!



Caution: Failure to wear proper eye protection can result in eye injury due to particles suspended in the air. Always wear proper eye protection to protect your vision!

- Do not employ the foot switch when only the compressed air supply hose is connected. The loose hose could wrap around itself and cause serious injury.

3.1 Liability Exclusion

Renfert GmbH shall be absolved from all claims for damages or warranty if:

- The product is employed for any purposes other than those cited in the operating instructions;
- The product is altered in any way other than those alterations described in the operating instructions;
- The product is repaired by other than an authorized facility or if any but Renfert OEM parts are employed;
- The product continues to be employed, despite obvious safety faults.
- The product is subjected to mechanical jarring or is dropped.

4. Installation / Commissioning

4.1 Setting up and Connecting the Unit with Foot Switch

1. Inspect the tank for proper installation (Fig. 1).
2. Connect the foot switch / sandblasting unit (red) (Fig. 2a, 2b, 2c).
3. Connect the foot switch / air supply (P) (Fig. 3).
4. Do not bend or kink the hose (Fig. 4)!

4.2 Setting up and Connecting the Unit without Foot Switch

1. Inspect the tank for proper installation (Fig. 1).
2. Connect the compressed air hose / sandblasting unit (red) (Fig. 2a, 2b, 2c).
3. Connect the compressed air hose / air supply (P) (Fig. 3).
4. Do not bend or kink the hoses (Fig. 4)!

4.3 Adjusting the Operating Pressure

1. Put in shut off-valve in a vertical position (Fig. 5).
2. Set the blasting pressure from 1 - 6 bar [14.5 - 87 psi] (Fig. 7) and in case you use a foot-switch, it has to be pressed additionally (Fig. 6).

4.4 Filling the Sandblasting Tank

 **Close the shut-off valve before filling the tanks (Fig. 11). Before closing the tank, clean the threads in the cover and on the tank, in order to remove any abrasive residue.**

1. Unscrew the tank cover (Fig. 8).
2. Add abrasive up to the maximum fill level (the point where the tank jacket thickens just below the thread) (Fig. 9a + 9b). Make sure the abrasive being used is compatible with the sandblasting tank.
3. Reinstall the tank cover (Fig. 10).

 **Do not cross-thread the cover.**

Always use only clean, dry abrasive of the appropriate grain size (refer to the accessories).

The sandblasting unit is now operational.

5. Cleaning / Maintenance

 **Use only solvent-free cleansers (e.g., soapy water). Wipe out the tanks and lids only with a dry cloth!**

5.1 Condensation

1. Inspect the water separator.
2. Close the shut off-valve (Fig. 11).
3. Drain any water off through the valve (Fig. 12), employing the foot switch (Fig. 6).

5.2 Blasting Nozzle Replacement

1. Refer to insert no. 21-9162 for installation.
2. Inspect for abrasive residue.
3. Inspect the seal ring position.

5.3 Sandblasting Hose Replacement

1. Disconnect the foot switch from the air supply (Fig. 3).
2. Refer to insert no. 21-9162 for the installation instructions.

6. Spare Parts

For the order numbers of consumables and spare parts please refer to the spare parts list at the end of this manual.

7. Warranty

Provided the unit is properly used, Renfert warrants all parts of the *Basic mobil* for a **period of 3 years**. In case of any claims for warranty original dealers' invoice is required. Components subject to natural wear (e.g., blasting nozzles, hoses, filter materials, etc.) are excluded from this warranty. The warranty is voided in case of improper use; failure to observe the operating, cleaning, maintenance, and connection instructions; in case of independent repairs or repairs by unauthorized personnel; if spare parts from other manufacturers are employed, or; in case of unusual influences or influences not in compliance with the utilization instructions. Warranty service shall not extend the original warranty.

8. Technical Specifications

Working pressure:	1-6 bar [14.5-87 psi]
Connecting pressure, external:	6-8 bar [87-116 psi]
Air consumption:	120 l/min. at 6 bar [87 psi]
Ø hose connection:	interior: 4 mm [0,16 inch] exterior: 6 mm [0,24 inch]
Dimensions (WxHxD):	220 x 260 x 130 mm [8.67 x 10.24 x 5.12 inch]
Tank capacity:	1000 ml
Weight (empty):	approx. 2.5 kg
Noise level:	< 70 dB(A)

9. Notes

Flat blasting with sheet dies:

Art. No. 90002-1207	0.3 x 3.5 mm [0.012 x 0.138 inch]
Art. No. 90003-1739	1.5 x 3.5 mm [0.059 x 0.138 inch]

When blasting glass ceramics, refer to manufacturer's notes.

10. Standard Delivery

- 1 *Basic mobil*
- 1 Foot switch (only with no. 2914-3050 / 2914-3250)
- 1 Connection set
- 1 Set of Operating Instructions, with attachment
- 1 Sample of blasting material

11. Delivery Versions

No.2914-3050 *Basic mobil* 25-70 µm, with foot switch

No.2914-3250 *Basic mobil* 70-250 µm,
with foot switch

12. Accessories

Abrasives

Cobra aluminium oxide

No.1594-1105 25 µm [500 mesh], white 5 kg canister

No.1594-1205 50 µm [270 mesh], white 5 kg canister

No.1594-2220 50 µm [270 mesh], white 20 kg bucket

No.1584-1005 90 µm [170 mesh], white 5 kg canister

No.1583-1005 110 µm [150 mesh], white 5 kg canister

No.1583-1020 110 µm [150 mesh], white 20 kg bucket

No.1587-1005 125 µm [115 mesh], pink 5 kg canister

No.1587-1020 125 µm [115 mesh], pink 20 kg bucket

No.1585-1005 250 µm [60 mesh], white 5 kg canister

No.1585-1020 250 µm [60 mesh], white 20 kg bucket

Rolloblast glass beads

No.1594-1305 50 µm [400-200 mesh] 5 kg canister

No.1594-2312 50 µm [400-200 mesh] 12.5 kg canister

No.1589-1005 100 µm [170-100 mesh] 5 kg canister

13. Troubleshooting Guide

Problem	Possible cause	Corrective action
No air and no abrasive.	<ul style="list-style-type: none"> Blasting nozzle blocked at the hand-piece. Foot switch connecting lines kinked. 	<ul style="list-style-type: none"> Unscrew the nozzle from the hand-piece and blow it out. With the nozzle removed, blow out the blasting hose by activating the foot pedal. Inspect/correct the connection lines.
Only air, no or very little abrasive.	<ul style="list-style-type: none"> The dosage nozzle in the mixing chamber is blocked due to contaminated or moist sand. Mixing chamber filter combination blocked. Abrasive contains impurities or is moist. 	<ul style="list-style-type: none"> Wear protective goggles. Unscrew tank lid. Remove sand. Close the uptake tube (blue tube) in the tank (by bending), so that no air can escape. Hold the sandblasting nozzle on the handpiece closed with the other hand. Using a setting of 4 to 6 bar pressure, activate the foot switch repeatedly in succession. Before re-filling with sand, check the tank and sandblasting material for contamination or moisture. If necessary replace with new sand. Re-fill with sand and secure the tank lid. (Continue sandblasting in the usual manner). <p>Install new filter sets:</p> <ul style="list-style-type: none"> - Part no. 90002-8889 25-70 µm - Part no. 90002-8888 70-250 µm <p>(Refer to the insert for the appropriate filter set):</p> <ul style="list-style-type: none"> Disconnect the compressed air supply to the mixing chamber. Unscrew the plug-in connection. Remove the old filter sets. Run a thin (1 mm) wire through the opening in the mixing chamber. Install new filter sets as follows (number of components according to the filter set– smooth (colour marked) side facing the mixing chamber): <ol style="list-style-type: none"> Screen Filter, thin Filter, thick Screen Spacer <p>Reinstall the screw-on connections in the reverse order. Make certain there is no abrasive residue on the threads.</p> <p>Attention: Never operate the unit without filters! Do not reinstall used filter sets!</p> <ul style="list-style-type: none"> Replace the abrasive.
Unit blasts continuously.	<ul style="list-style-type: none"> Foot switch connected incorrectly. Valve in foot switch is defective. 	<ul style="list-style-type: none"> Inspect/correct the foot switch connection. Replace foot switch.
Compressed air leaking from the foot switch.	<ul style="list-style-type: none"> Pneumatic hoses reversed. 	<ul style="list-style-type: none"> Reverse the connections.
Foot switch fails to switch on.	<ul style="list-style-type: none"> No pressure at the compressed air connection. Pneumatic hoses are kinked. 	<ul style="list-style-type: none"> Inspect the compressed air lines and/or the compressor. Reposition the hoses.